

# PANEL-MOUNTED SOCKET OUTLETS ANGLED

according to IEC 60309, EN 60309, VDE 0623



## PANEL-MOUNTED SOCKET OUTLET ANGLED 15°

watertight IP67

- HighPower version
- with pilot contact
- screw terminals
- nickel-plated contacts
- with flange 107 x 100 mm

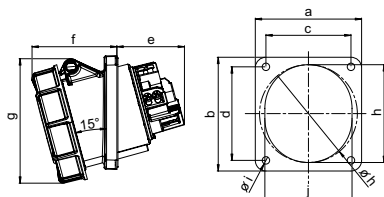

POLES	3	4	5
AMPERE	63		

Flange a	100	100	100
Flange b	107	107	107
Hole spacing c	77	77	77
Hole spacing d	85	85	85
e	64	64	64
f	80	80	80
g	119	119	119
h	92	92	92
i	7	7	7
j	82	82	82
Weight [g/each]	491	536	591

VOLTAGE	230 V~	400 V~	440 V~	500 V~
FREQUENCY	50/60 Hz	50/60 Hz	50/60 Hz	50/60 Hz
DESIGNATION	3p = 6h 4p/5p = 9h	3p = 9h 4p/5p = 6h	11h	7h

AMPERE	POLES	ITEM NO.	ITEM NO.	ITEM NO.	ITEM NO.	PACKING UNIT
63	3	F33S284			F33S584	2
63	4	F43S284	F43S384	F43S484	F43S584	2
63	5	F53S284	F53S384		F53S584	2



## PANEL-MOUNTED SOCKET OUTLET ANGLED 15°

watertight IP67

- HighPower version
- with pilot contact
- screw terminals
- nickel-plated contacts
- with flange 114 x 114 mm

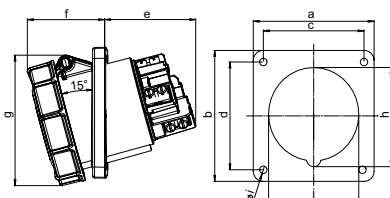

POLES	3	4	5
AMPERE	125		

Flange a	114	114	114
Flange b	114	114	114
Hole spacing c	90	90	90
Hole spacing d	90	90	90
e	92	92	92
f	77	77	77
g	130	130	130
h	102	102	102
i	7	7	7
j	90	90	90
Weight [g/each]	792	880	987

VOLTAGE	230 V~	400 V~	440 V~	500 V~
FREQUENCY	50/60 Hz	50/60 Hz	50/60 Hz	50/60 Hz
DESIGNATION	3p = 6h 4p/5p = 9h	3p = 9h 4p/5p = 6h	11h	7h

AMPERE	POLES	ITEM NO.	ITEM NO.	ITEM NO.	ITEM NO.	PACKING UNIT
125	3	F34S288			F34S588	2
125	4	F44S288	F44S388	F44S488	F44S588	2
125	5	F54S288	F54S388		F54S588	2