

# APPLIANCE INLETS

according to IEC 60309, EN 60309, VDE 0623



## APPLIANCE INLET STRAIGHT

watertight IP67

- HighPower version
- nickel-plated contacts with pilot contact
- screw terminals

Watertight cap see page 21

IP44 upon request

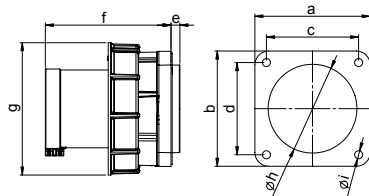

POLES	3	4	5	3	4	5
AMPERE	63			125		

axb	100	100	100	120	120	120
cxb	80	80	80	100	100	100
e	8	8	8	13	13	13
f	109	109	109	118	118	118
g	115	115	115	131	131	131
h	77	77	77	95	95	95
i	7	7	7	7	7	7
Weight [g/each]	479	531	570	786	891	998

VOLTAGE	230 V~	400 V~	500 V~
FREQUENCY	50/60 Hz	50/60 Hz	50/60 Hz
DESIGNATION	3p = 6h 4p/5p = 9h	3p = 9h 4p/5p = 6h	7h

AMPERE	POLES	ITEM NO.	ITEM NO.	ITEM NO.	PACKING UNIT
63	3	A33S27		A33S57	2
63	4	A43S27	A43S37	A43S57	2
63	5	A53S27	A53S37	A53S57	2
125	3	A34S27		A34S57	2
125	4	A44S27	A44S37	A44S57	2
125	5	A54S27	A54S37	A54S57	2